

TILLAMOOK COUNTY SURVEYORS OFFICE  
TILLAMOOK COUNTY COURT HOUSE  
201 LAUREL AVENUE  
TILLAMOOK, OREGON 97141

1/4 CORNER COMMON SECTIONS 22 & 27, T.3S., R.10W., W.M.

T3SR10W	
1 S22	I found a 2 1/2" iron pipe with a 3" B.L.M. Brass
/ ----+----	Cap, (see T.C.S. Rewitness Book 6 Page 99 & 100).
4 S27	I encased the found iron pipe in a 10" concrete
1978	cylinder.

-----  
History of found monument

I found this monument to be as described in T.C.S. Rewitness Book 6 at Pages 99 & 100, and the references found and/or set at that time to now be as follows:

(Original) set post for corner; (Now gone).

(Original) 24" fir N.10°E. 17 lks., reported on Rewitness Card #633 as a 30" snag, scribing gone; (Now missing).

(Original) 20" fir S.72°W. 10 lks., reported on Rewitness Card #633 as a 32" snag, scribes "1/4 S BT" visible, and in Rewitness Book 6 at Page 100 as a decayed fir stump scribe marks visible, and on T.C.S. Map #B-1085 as a 30" D. fir stump 5' high with scribes; (Found, now a 29" stump 5' high no scribing visible).

(Book 2 Page 258) 30" fir N.5°W. 26 lks scribed 1/4S BT, and reported in T.C.S. Rewitness Book 6 at Page 100 as a 35" fir N.6 1/2°W. 30 lks., with healed blaze, and reported on T.C.S. Rewitness Card #633 as a 30" fir N.7°E. 18 1/2' scribing visible, and reported on T.C.S. Map B-1085 as a 35" D. fir N.7°E. 20.3', 19' to face; (Found, now a 38" fir, with healed face, N.7°W. 18.89' to a nail with a T.C.S. Brass Washer in a small blaze facing the corner).

(Book 2 Page 258) 24" fir S.7°E. 18 lks scribed 1/4S BT, and reported in T.C.S. Rewitness Book 6 at Page 100 as a 29" fir S.7°E. 20 lks., with healed blaze, and reported on T.C.S. Rewitness Card #633 as a 24" fir S.7°E. 12' scribing visible, and reported on T.C.S. Map B-1085 as a 31" D. fir S.7 E. 12.5'; (Found, now a 33" fir, with healed face, S.7°E. 11.39' to a nail with a T.C.S. Brass Washer in a small blaze facing the corner).

(Book 2 Page 258) set iron pipe for corner, Rewitness Card #633 found 1/2" iron pipe and set 3/4" iron pipe 30" high, Book 6 at Page 99 set iron post with B.L.M. Brass Cap for corner, and set steel fence post and found iron pipe alongside of corner, (I found a steel fence post with yellow attention tag 3' Westerly of corner.

Page 1 of 2

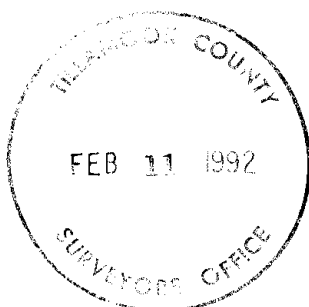

BOOK 7 128-A

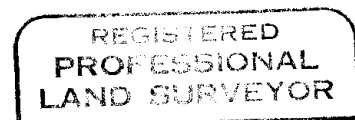

*Allan E. Duncan, C.S.*

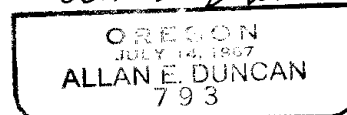

TILLAMOOK COUNTY SURVEYORS OFFICE  
TILLAMOOK COUNTY COURT HOUSE  
201 LAUREL AVENUE  
TILLAMOOK, OREGON 97141

1/4 CORNER COMMON SECTIONS 22 & 27, T.3S., R.10W., W.M.

New Accessory

\*72" light hat section post North 1.5'.

Attached a yellow metal location poster on a 4" alder on the North side of an old alder covered road inscribed 1/4 cor approx. N.10 E. 27'.

\*indicates Tillamook County Surveyors yellow metal location poster attached.

Surveys and Rewitnesses of record

B-1085	12-24-82	Edgar E Cook	LS 1073
		& David K. Bateman	LS 1068
Rewitness Book 6 Pages 99 & 100	2-27-78	B.L.M.	
Rewitness Card #633	1-24-69	Leonard Whitmore	U.S.F.S.
Rewitness Book 2 Pages 258	3-19-52	Mervin Whitmore	U.S.F.S.
G.L.C. Book 3S10 Page 28	8-14-1882	Wm. P. Wright	
		contract #442	

Location of Monument

This corner is located approximately 125' East of the West end of an old alder covered road and approximately 30' North of this road.

In the presence of Al Dvorak and Dan McNutt

January 14, 1992

Title

Page 2 of 2

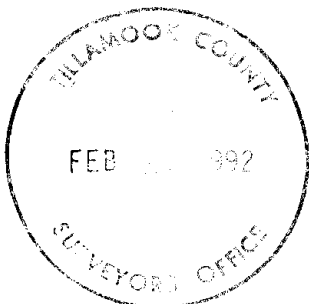

BOOK 7 128-B

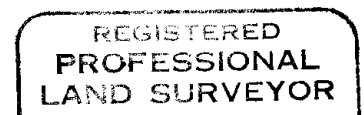

*Allan E. Duncan, L.S.*

